

| REVISIONS |     |                               |          |       |
|-----------|-----|-------------------------------|----------|-------|
| P         | LTR | DESCRIPTION                   | DATE     | APVD  |
|           | A   | NEW RELEASE PER ECO-14-012863 | 08-27-14 | DM DM |

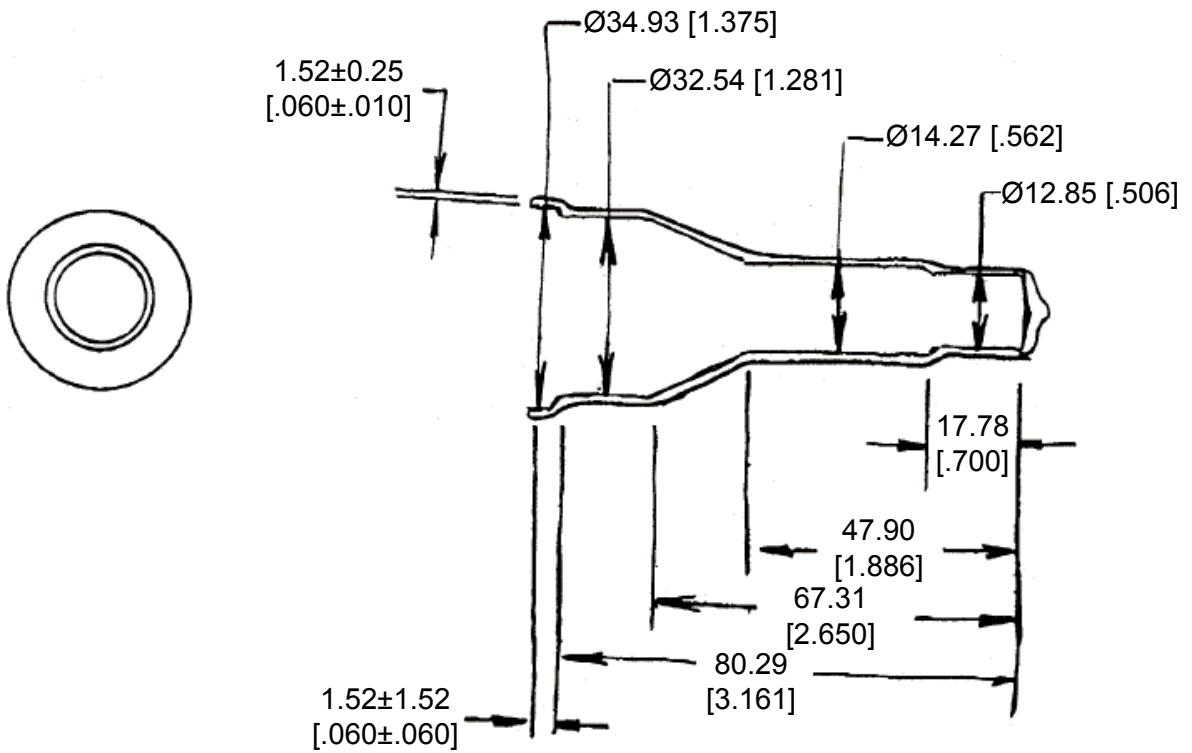

3. PART NO. HD10-6BT
2. TEMPERATURE RATING: -29°C TO +100°C [-20°F TO +212°F]
1. THIS PART IS USED ON  
 HD10-6-XXX RECEPTACLES  
 HD14-6-XXX-RECEPTALCES  
 HD16-6-XXX PLUGS  
 WHERE XXX IS PIN ARRANGEMENTS. SEE INVIDUAL CUSTOMER DRAWINGS

2014

RELEASED FOR PUBLICATION

ALL RIGHTS RESERVED.

© COPYRIGHT 2014 BY TE CONNECTIVITY

THIS DRAWING IS UNPUBLISHED.

|  |                               |                  |                 |
|--|-------------------------------|------------------|-----------------|
| DIMENSIONS:<br><b>MM [INCH]</b>        | DWN D. MEYER 27AUG2014        | MATERIAL PVC     | FINISH GRAY     |
|  | CHK I. GRANTCHAROVA 27AUG2014 | TE Connectivity  |                 |
| TOLERANCES UNLESS OTHERWISE SPECIFIED: | APVD D. MEYER 27AUG2014       |                  |                 |
| 0 PLC ±                                | PRODUCT SPEC                  | SIZE A 4         | CAGE CODE 4AFU8 |
| 1 PLC ±                                | APPLICATION SPEC              | DRAWING NO       | RESTRICTED TO   |
| 2 PLC ± 0.63 [.025]                    |                               | Customer Drawing | © - HD10-6BT    |
| 3 PLC ±                                | WEIGHT 11.00 g                | SCALE NONE       | SHEET 1 OF 1    |
| 4 PLC ±                                |                               | REV A            |                 |
| ANGLES ± 5°                            |                               |                  |                 |

